



### HEALTHCARE TAPWARE

#### Thermostatic shower mixer tap with 150 mm span - 75640



#### Benefits of the product

- Anti-scalding safety device on the thermostatic cartridge, NF EN 1111 compliant: the water stops flowing if the cold water supply is cut
- Cool body
- Temperature stopper blocked at 38°C: anti-scalding safety - can be unlocked by the user up to 48°C.
- Water flow knob with unlockable stopper at the half-way point

#### Description

Thermostatic shower mixer tap with 150mm span, wall-mounted, cool body. A double flow knob and a temperature knob blocked at 38°C (temperature stopper), but unlockable by the user up to 48°C. Offset M1/2 connectors with chrome-plated wall trim and filter gaskets. Cold/Hot water inlet with check valve, M'1/2 shower outlet. Ceramic ½ turn head for flow regulation and NF EN 1111 compliant thermostatic cartridge for temperature regulation. Body and knobs in polished chrome-plated brass. 3-Year guarantee for the thermostatic cartridge and 10-year guarantee for the remaining tapware. Sanifirst brand type thermostatic shower mixer tap with 150mm span REF: 75640 or approved equivalent

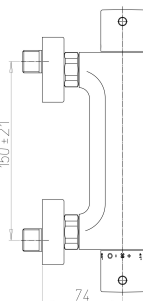
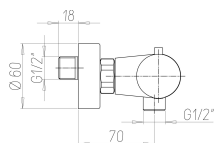



## TECHNICAL DATASHEET

### Additional Information

<b>Product reference</b>	75640
<b>Previous reference</b>	NC
<b>Brand</b>	Sanifirst
<b>Warranty</b>	10 years against manufacturing defects - 3 years for the thermostatic cartridge
<b>Special feature 1</b>	Thermostatic mixer tap
<b>Special feature 2</b>	Wall-mounted
<b>Clip-on spout</b>	No
<b>Lever</b>	Brass knob
<b>Lever</b>	Flow rate knob with possibility to unlock the flow rate at halfway point
<b>Connection</b>	Pair of rosette and offset G'1/2 G'3/4 connectors – captive nut G'3/4 – Span 150 mm
<b>Head</b>	1/2 turn ceramic head