



TECHNICAL DATASHEET

LABORATORY TAPWARE

Single hole tap, fixed or adjustable (optional) black - 76068



Photo représentant le H6030PT

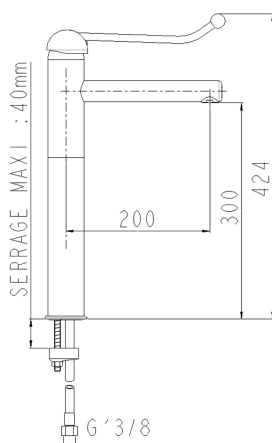

Benefits of the product

- Fixed or swivel spout (optional)

We have created a range from our range tall hospital mixers with fixed or swivel spouts (optional) for use in the laboratory. Versions with black, grey and white Rilsan covering offering chemical resistance far superior to chrome or epoxy. Clear advantages in terms of durability and hygiene.

Description

Single hole laboratory fixed or swivel mixer (optional) without drain for ceramic surface or bench with 170mm long medical handle avoiding manual contact, using elbow, forearm or wrist. Fixed or swivel spout (optional), smooth and removable for disinfecting L 200mm. Height to nozzle 300mm suitable for end filtration. Height and length of spout adapted without changing the entire tapware. Multifunction ceramic cartridge Ø 40: 7-setting temperature limit stop, dual flow and flow settings from 2l to 12l/min. Tapware with star-shaped flow straightener reducing scaling, eliminating water retention and impurities; withstands thermal and chlorine shocks Smooth body, spout and control knob in polished chrome-plated brass with black Nylolac coating (stronger than simple Epoxy finish). SPEX stainless steel braided hoses, M10x1 LN G'3 / 8 L 650mm Reinforced fixation by a stainless steel rod. 5 year warranty. Chlorine and thermal shock resistant. First Labo brand single hole laboratory mixer with smooth removable spout for hand wash basin REF: 76068 (formerly H6031PT) or approved equivalent.



TECHNICAL DATASHEET

Additional Information

Product reference	76068
Previous reference	H6031PT
Brand	FirstLabo
Warranty	5 years against manufacturing defect
Special feature 1	Laboratory mixer tap
Special feature 2	Tabletop
Special feature 3	Removable spout
Additional information	With removable spout
Height to nozzle (mm)	300
Projection (mm)	200
Connection	SPEX hose 650 mm - M10x1 - LN G'3/8
Flow rate	12
Adjustable flow rate	Yes
Dual flow rate	Yes
Minimum pressure	1 bar
Recommended pressure	3 bar
Maximum pressure	5 bar
Blocking temperature	Yes
Max tightening	40
Packing	1