

Range: Self-closing flush valves

Ref: 14252 - PRESTO 1000 XL E - ECO 4L type

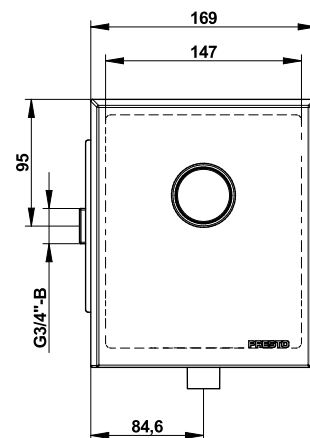
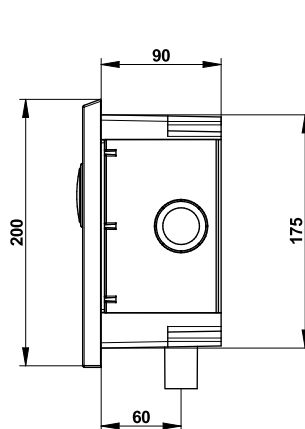

> Working pressure :

- 1 to 5 bar

> Discharge volume per flush :

- 4l ± 1l
- Anti-water-hammering device
- Automatic 1 l/s flow limiter, 1.2 to 4 bar dynamic working pressure

> Flow time :

- 4 seconds ± 1 second

> Hydraulic supply :

- Right or left square M G 3/4" (20x27)
- Outlet connection on flush pipe Ø 28 mm

> Material and colour finish :

- Brass body
- Stainless steel vandal-proof front plate

> Security :

- Vacuum breaker device prevents the contamination of the water network from polluted water backflow
- Patented anti-blocking "S" system preventing the tap to be blocked in open position to avoid continued water flow

> Delivered with:

- 1 Concealed ABS case
- 1 Stainless steel front plate with chrome-plated brass button
- 1 Flush valve P1000XL ECO 4L type with integrated stop-valve
- 1 Instruction manual

> Standards & approvals :

- Brass body in accordance with EN 1982, EN 12164, EN 12165
- Nickel-Chrome plated according to EN12540
- 200-hour neutral salt spray resistant (NSS) in accordance with ISO 9227

