

TECHNICAL DATA SHEET

PRESTO®

sanifirst

Range: Sanifirst - Healthcare taps

Ref: 75072 - Hospital shower mixer - Full lever

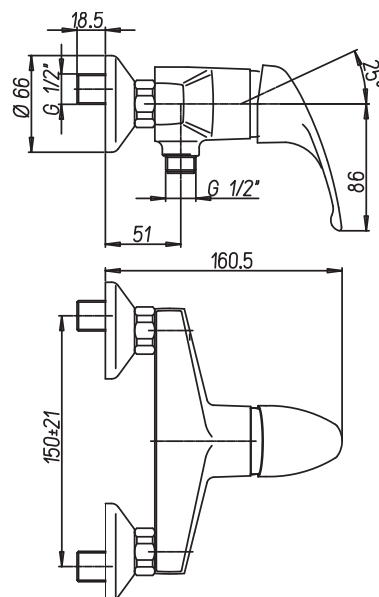

> Benefits of the product

- Solid easy maintenance handle
- Integrated check valves at the level of the shower outlet.
- Multifunctional cartridge: temperature limiter with 7 adjustment positions, double flow (hard point at 50% opening).
- Flow between 9 and 12 L / min at 3 bar - in accordance with the French norm standard "Medical"; possible flow modification, in case of disassembly of the limiters, by adjusting screw between 9 and 20 L / min.
- Water savings, safe operation and controlled water consumption.

> Model

- 150 mm span Shower mixer.
- Full lever
- Ceramic cartridge diameter 40 mm with double flow, temperature limiter with 7 adjustment positions.

> Flow rate

- between 9 and 12 L / min at 3 bar - in accordance with the NF "Medical environment" standard; modification of the flow rate possible, if the limiters are removed, by adjusting screw between 9 and 20 L / min.

> Recommended pressure

- 3 bar - avoid pressure differences greater than 1 bar between DHW and DCW.
- Minimum pressure: 1 bar.
- Maximum pressure: 5 bar.

> Materials

- Chromed brass.

> Connection

- captive nut G'3 / 4 supplied with rosettes and eccentric fittings M G'1 / 2 - M G'3 / 4.
- hower outlet M G'1 / 2 with integrated check valve

> Warranty

- 10 years against any manufacturing defect.

Ce document n'est pas contractuel ; nous nous réservons le droit de modifier les caractéristiques de nos produits sans préavis. Toutes nos marques et tous modèles sont déposés.

