

Range: Mastermix

Ref: 74030 - Mastermix thermostatic washbasin mixer - Fixed spout - Long ergonomic lever

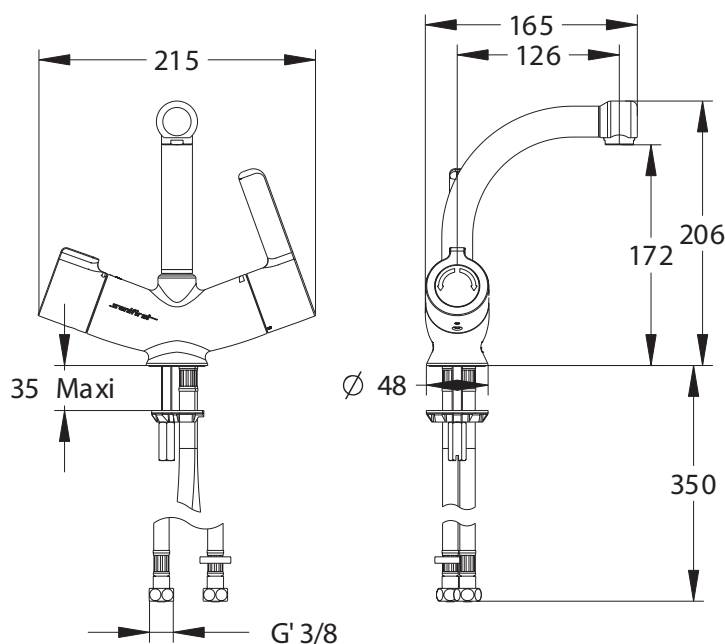

Benefits of the product

- MASTERMIX PATENTED RANGE
- Certified French Norm NF Medical
- Ingenious combination of a ceramic cartridge and thermostatic cartridge: safety and reliability.
- No cross-connection between hot water and cold water.
- Without check-valves
- Body and spout with smooth interior: limits the risk of bacterial proliferation
- Intuitive control units
- Safety temperature limiter (41°C) and adjustment of maximum flow limiter
- Temperature stability and anti-scalding safety
- Quick and easy installation and maintenance.
- Safe thermal shock: only accessible by technical staff

Anti-scalding safety

- Temperature knob with temperature stop at 41 °C. Unlocking secured for thermal shock and accessible only by technical services without removing the knob.

Anti-bacterial proliferation safety

- Unique DCW and DHW anti-intercommunication system, produced by the association of a specific ceramic cartridge and a thermostatic cartridge conforming to NF EN 1111.

Model

- Deck mounted washbasin mixer, without waste
- Height under spout: 172 mm
- Projection: 126 mm - Short fixed spout
- PMR (peolpe with reduced mobility) long lever
- Ceramic cartridge and thermostatic cartridge conforming to NF EN 1111

Flow rate

- Factory set at 6 L / min.
- Maximum flow rate adjustable to 6 - 9 - 12 L / min by the manager.

Recommended pressure

- 3 bar - avoid pressure differences greater than 1 bar between DHW and DCW.
- Minimum pressure: 1 bar.
- Maximum pressure: 5 bar.

Materials

- Knobs in chromed Zamak.
- Chromed brass spout.
- Forged brass body.

Connection

- Flexible M10x1 captive nut G'3 / 8 Lg 350 mm, and filter seal

Warranty

- 10 years against any manufacturing defect.
- 3 years for the thermostatic cartridge.